

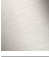



13 801 670

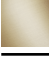

- Ausladung 200 mm
- rechteckiger Normalstrahl
- Bohrungsdurchmesser 37 mm
- Anschluss 1/2"
- Durchfluss max. 25,1 l/min bei 3 bar Fließdruck

	Chrom	13 801 670-00
	Platin gebürstet	13 801 670-06
	Dark Chrome	13 801 670-19
	Light Gold gebürstet	13 801 670-27
	Schwarz matt	13 801 670-33
	Chrom gebürstet	13 801 670-93

**Empfohlenes Zubehör**



- UP-Wandwinkel -** 35 085 970 90
- Max. Einbautiefe 163 mm
  - Min. Einbautiefe 90 mm

13 801 670

mm [inches]

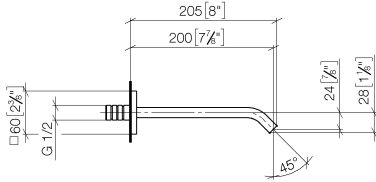

Durchflussdiagramm

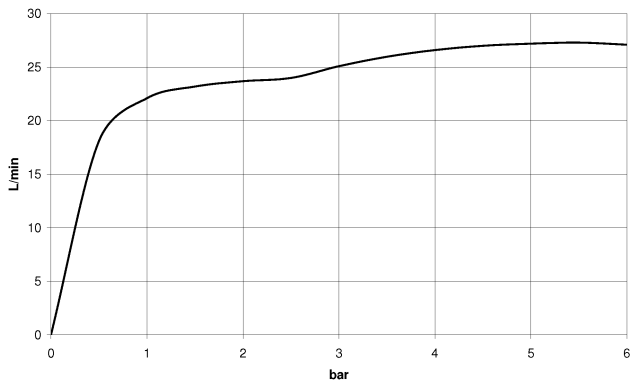

Codes & Standards

ASME A112.18.1

cUPC

Scottish Water  
Byelaws

UK Water Supply  
Regulations



## IMO Wannenauslauf für Wandmontage - Chrom

---

IMO

13 801 670

### Zertifikate

---

WRAS\_2005

IAPMO\_4976

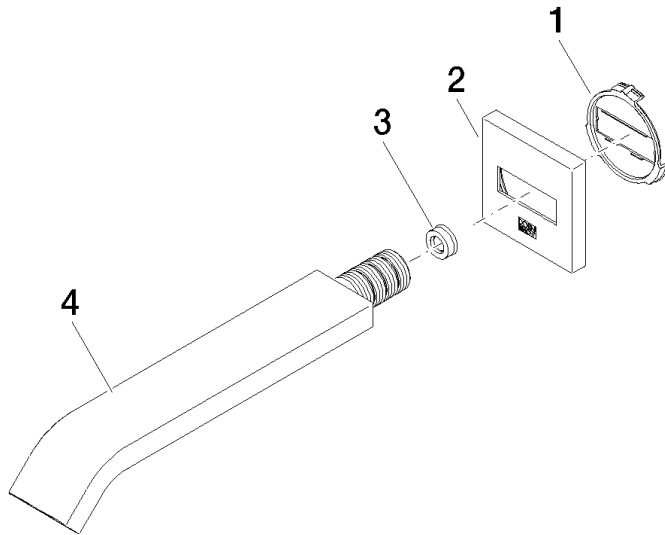



# IMO Wannenauslauf für Wandmontage - Chrom

IMO

13 801 670

## Ersatzteilstückliste

Nr.	Artikelnummer	Benennung	Verbaumenge	Lieferzeit
	09 18 40 139 90	Halter 51x 6,5 x 51 mm -	4	2